



COMMERCIAL REAL ESTATE CONSULTANTS

WWW.CRCNATIONWIDE.COM

9400 SOUTH 751 EAST - SANDY 84070

PROPERTY INFORMATION

- **Suite 751: 1,257 SF Available**
- Available March 1, 2016
- Great Location
- High Traffic Counts!
- Co Tenants Include:
 - Pep Boys
 - Cyprus Credit Union
 - Tandy Leather
 - Deseret Industries
 - Biomat USA
 - Check 'n Go
 - Canyon View Cleaners

FOR LEASE

LAST UNIT AVAILABLE



LEASE RATE: \$750.00/MONTH NNN

TRAFFIC COUNTS: 44,565 TOTAL ADT!

9400 South 17,435 ADT

700 East 27,130 ADT

DEMOGRAPHICS

	3 MILE	5 MILE
Population	126,489	280,394
Avg Household Income	\$73,377	\$80,124



**COSTAR
POWER BROKER AWARD
TOP FIRM
2010, 2011, 2012, 2013, 2014, 2015**

CHECK US OUT AT...



cRc Nationwide | 6135 S. Stratler Street, Suite A | Murray, UT 84107 | 801.617.1700 Office | 801.617.1701 Fax

801.617.1700

PAT BARTON
PAT.BARTON@CRCNATIONWIDE.COM

WEST HARADIN
WEST.HARADIN@CRCNATIONWIDE.COM



COMMERCIAL REAL ESTATE CONSULTANTS

WWW.CRCNATIONWIDE.COM

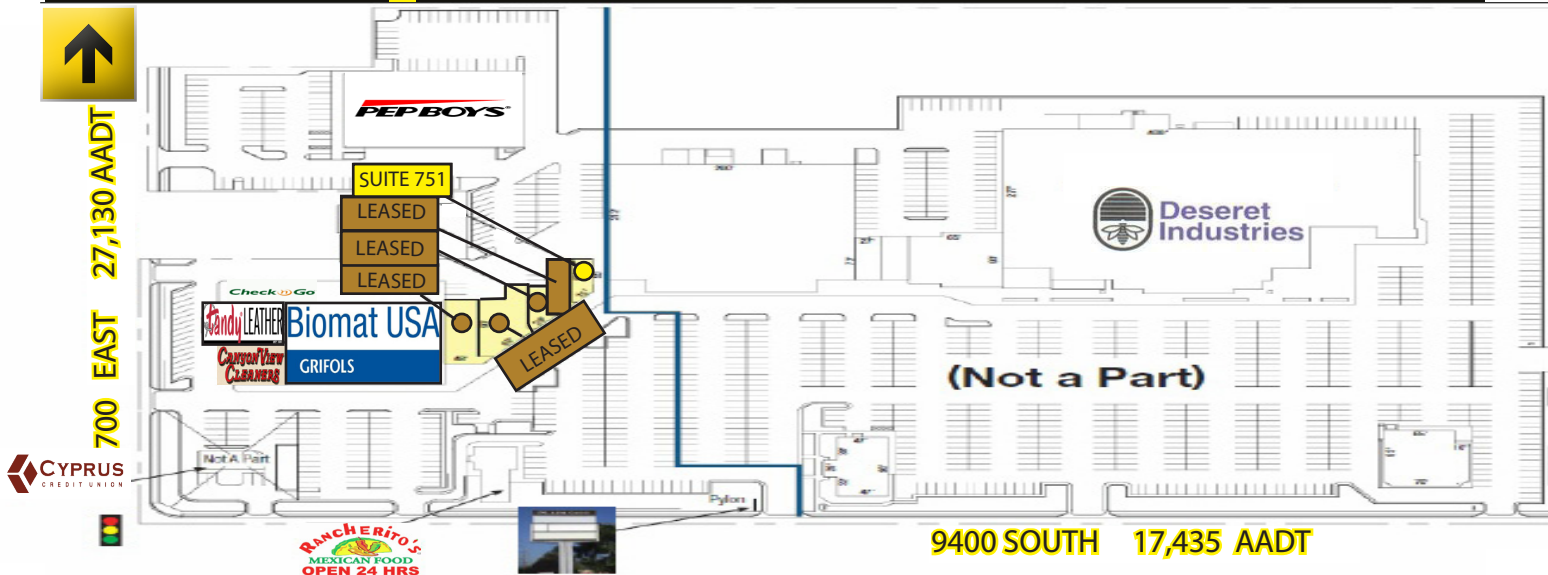

cRc Nationwide | 6135 S. Stratler Street, Suite A | Murray, UT 84107 | 801.617.1700 Office | 801.617.1701 Fax

This information is given with the understanding that all negotiations and/or real estate activity related to the property described above shall be conducted through this cRc Nationwide office. The above information while not guaranteed, was obtained from sources we believe to be reliable.

801.617.1700

PAT BARTON
PAT.BARTON@CRCNATIONWIDE.COM

WEST HARADIN
WEST.HARADIN@CRCNATIONWIDE.COM